

31.Floor Mat

A: REMOVAL

1) Disconnect the ground cable from battery. <Ref. to NT-5, BATTERY, NOTE, Note.>

NOTE:

- For models other than STI model, disconnect the ground terminal from battery sensor.
 - On CVT models, shift the select lever into "D" before disconnecting the battery ground cable.
- 2) Remove the front seat assembly. <Ref. to SE-9, REMOVAL, Front Seat.>
 - 3) Remove the rear seat cushion assembly. <Ref. to SE-29, REMOVAL, Rear Seat.>
 - 4) Remove the console box assembly, the cover - shift lever and the panel center LWR. <Ref. to EI-67, REMOVAL, Console Box.>
 - 5) Remove the lower inner trim on the RH and LH sides. <Ref. to EI-81, REMOVAL, Lower Inner Trim.>
 - 6) Remove the pull handle cover. <Ref. to SL-59, FUEL FLAP, REMOVAL, Remote Openers.>
 - 7) Remove the knobs of the hook - seat cushion rear.

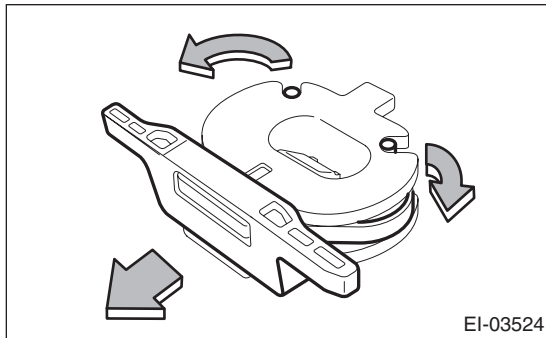

- 8) Take out the floor mat from the vehicle.
 - (1) Remove the clips from the floor mat.
 - (2) Remove the mat hook on both sides.
 - (3) Take out the floor mat after folding down.

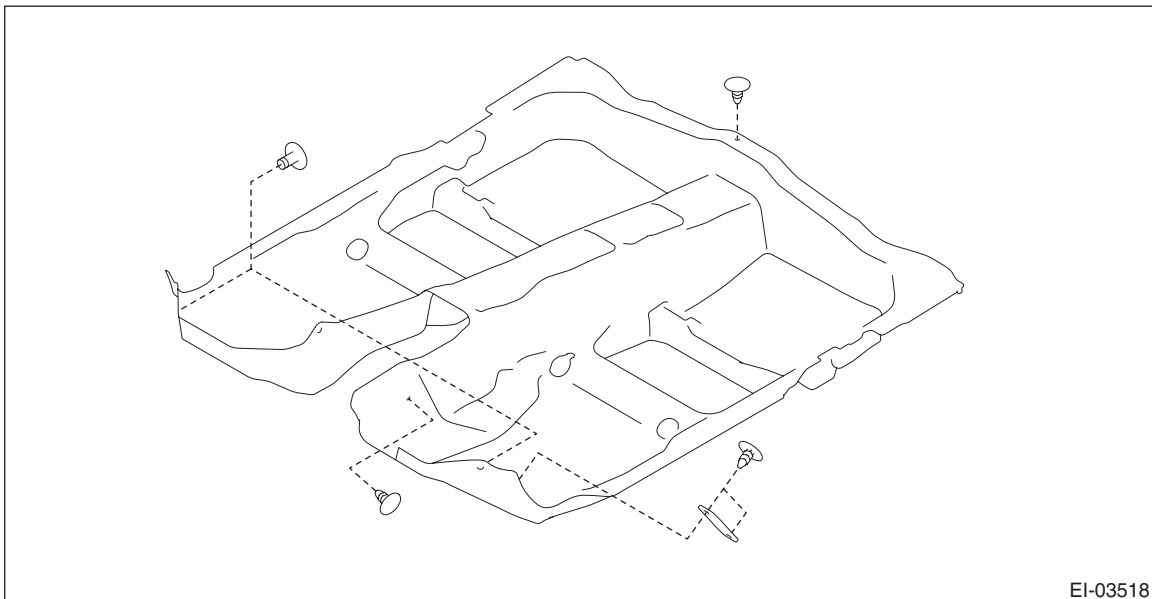

Floor Mat

EXTERIOR/INTERIOR TRIM

B: INSTALLATION

1) Bring the floor mat into the vehicle, and secure with the clips.

CAUTION:

Make sure that the knobs of the hook - seat cushion rear are securely installed.

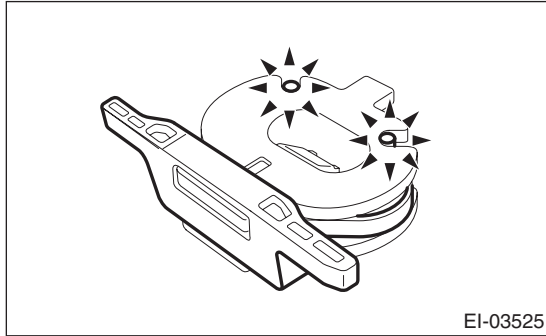

2) Install the pull handle cover.

3) Install the lower inner trim.

4) Install the console box assembly, the cover - shift lever and the panel center LWR.

5) Install the rear seat cushion assembly.

6) Install the front seat.

Tightening torque:

53 N·m (5.4 kgf·m, 39.1 ft·lb)

7) Connect the battery ground terminal. <Ref. to NT-5, BATTERY, NOTE, Note.>

NOTE:

For models other than STI model, connect the ground terminal to battery sensor.

EXTERIOR BODY PANELS



	Page
1. General Description	2
2. Front Hood	10
3. Front Fender	19
4. Front Door	24
5. Front Sealing Cover	32
6. Rear Door	34
7. Rear Sealing Cover	41
8. Door Sash Tape	42
9. Trunk Lid	51
10. Weather Strip	58